

THE IMPROVEMENTS COVERED BY THESE PLANS SHALL BE DONE IN ACCORDANCE WITH THE MICHIGAN DEPARTMENT OF TRANSPORTATION 2012 STANDARD SPECIFICATIONS FOR CONSTRUCTION.

PHYSICAL ROAD NUMBER (PR#) & MILEPOST (MP) DATA ARE FROM MICHIGAN GEOGRAPHIC FRAMEWORK VERSION # 16.

MICHIGAN DEPARTMENT OF TRANSPORTATION

**ROUTE: M-222
CITY OF ALLEGAN
ALLEGAN COUNTY**



ROAD	YEAR	TRAFFIC DATA			SPEED DATA		LIMITS
		ADT	DHV	COMM	DESIGN	POSTED	
M-222	2015	9100	966	3%	35	30	**

SECTION	CONTROL SEC	JOB NO.
	03041	107575

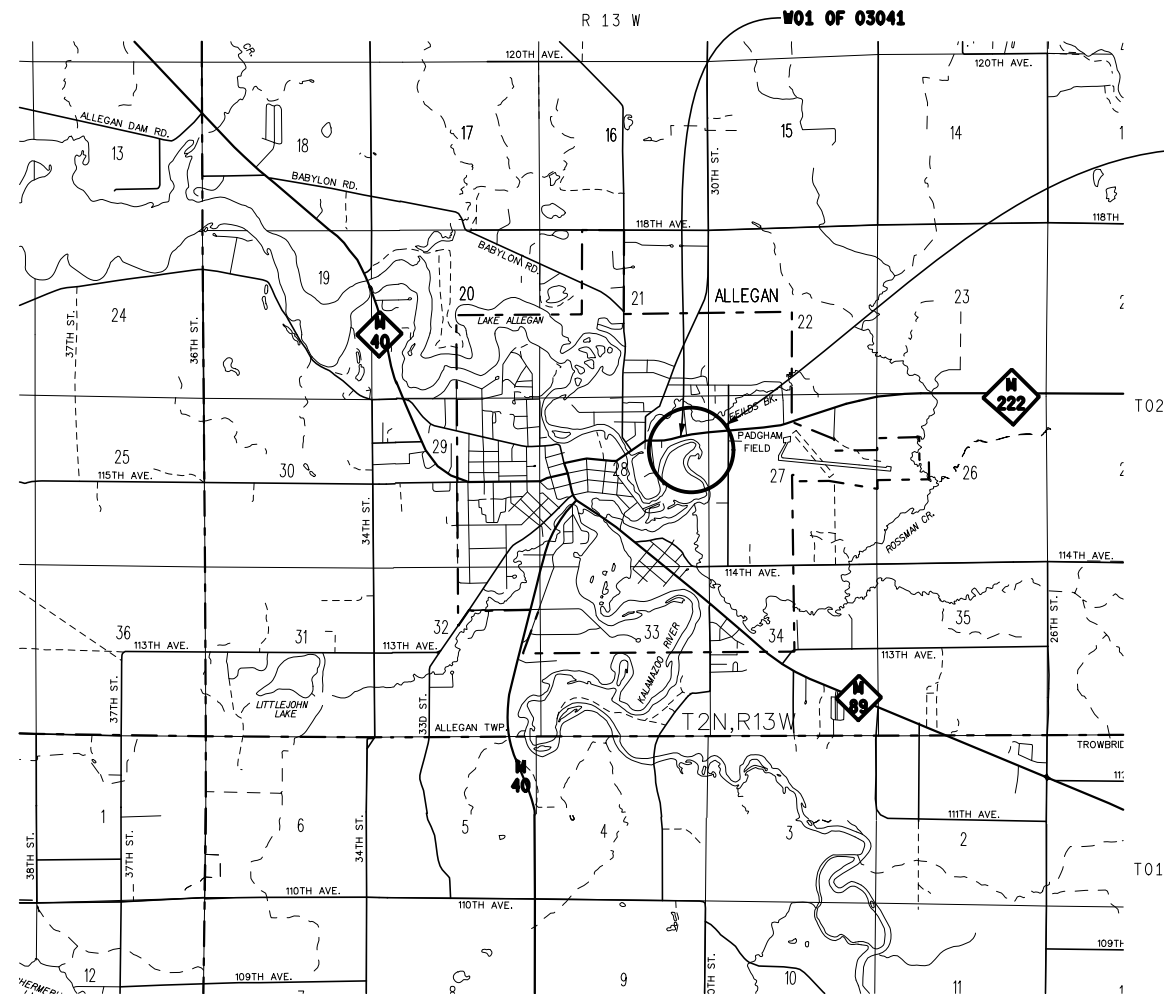

CS 03041
JN 107575
PR# 787604
PRMP = 0.925
CS 03041
CSWP = 0.852

APPROVALS

RECOMMENDED FOR APPROVAL BY:

_____ P.E. - PROJECT MANAGER

_____ NATHAN VAN DRUNEN, P.E. - CONSTRUCTION ENGINEER

**MICHIGAN
DEPARTMENT OF TRANSPORTATION**

KIRK T. STEUDLE, P.E. - DIRECTOR

MILES: 0.000
CONTRACT FOR:
SLOPE REPAIR, AND HAUL ROAD WORK

FINAL ROW PLAN REVISIONS		(SUBMITTAL DATE:)	
NO.	DATE	AUTH	DESCRIPTION



NO SCALE

DATE: 03/29/18	CS: 03041
DESIGN UNIT: FRANKLIN	JN: 107575A
TSC: GRAND RAPIDS	

SLOPE REPAIR DETAILS		DRAWING	SHEET
M-222 AT THE KALAMAZOO RIVER		M-222	SECT
		DET	1

FILE: 107575 2018 SLOPE title.dgn

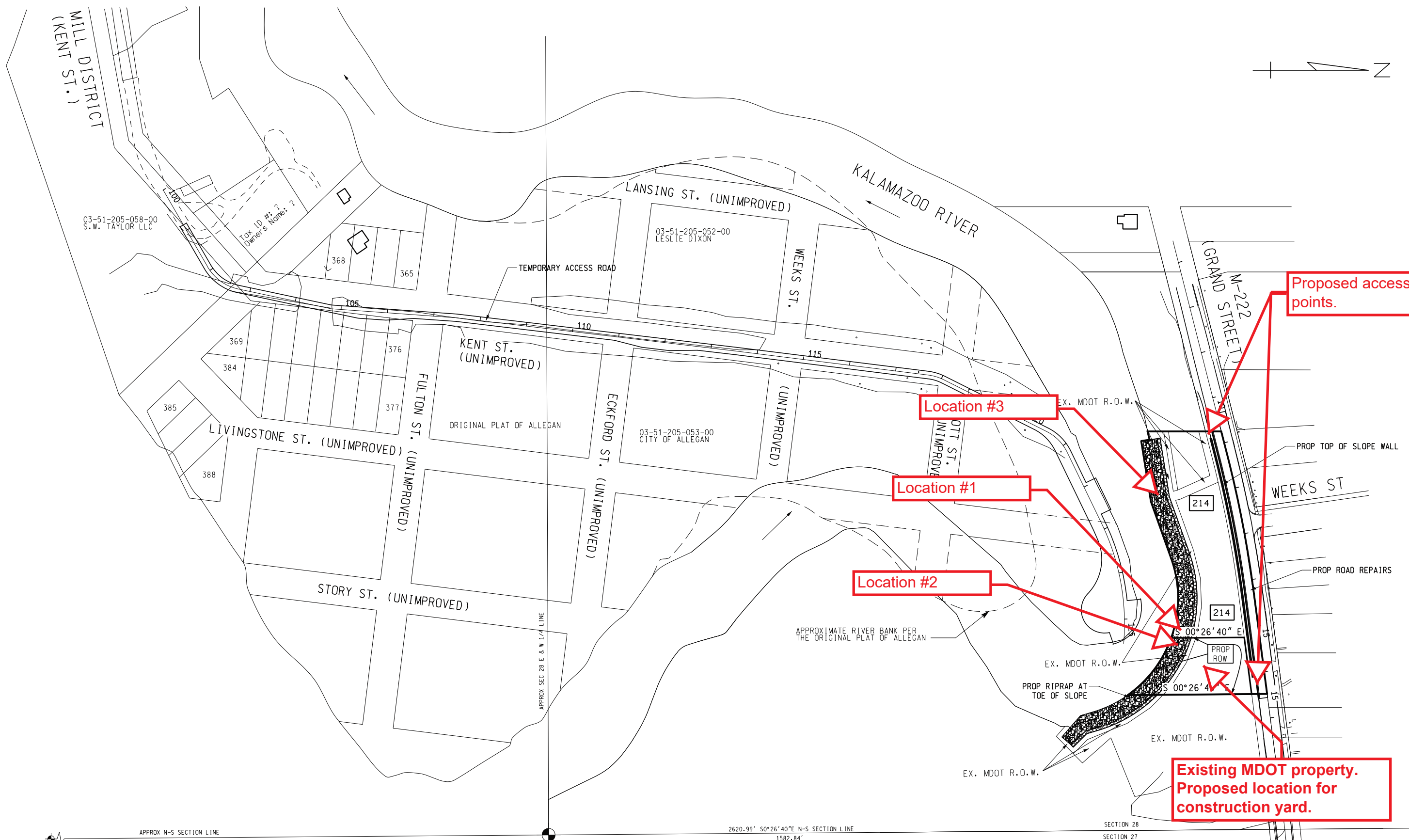
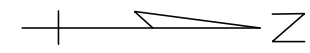

INFORMATION ONLY

* NO 0271A FORM SUBMITTED (REQUEST TO REVISE ROW)

FINAL ROW PLAN REVISIONS (SUBMITTAL DATE: 05/22/14)							
NO.	DATE	AUTH	DESCRIPTION	NO.	DATE	AUTH	DESCRIPTION
1	11/18/13	RR	ADDED PROPOSED ROW	3	2/27/16	RR	* ADDED PROPOSED ROW
2	05/22/14	RR	ADDED PROPOSED ROW & GRADING				

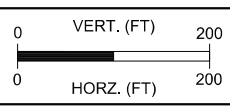

DATE: 05/12/14
 DESIGN UNIT: WILCOX
 TSC: KALAMAZOO
 FILE: 107575_01.VIC

CS: 03041
 JN: 107575B

VICINITY SHEET
 M-222

DRAWING SHEET
 M-222 ROW
 VIC001 503B

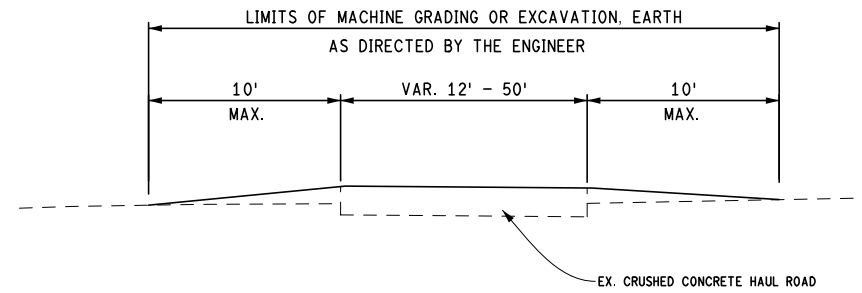

EXISTING CROSS SECTION
TO APPLY
STA. 115+00 TO STA. 125+00

NOTES:

1) MACHINE GRADING TO CONSIST OF VIBRATORY ROLLING THE EXISTING HAUL ROAD GRADE TO CONSOLIDATE UNDERLYING MATERIALS TO BRING THE HAUL ROAD GRADE FLUSH WITH THE ORIGINAL EXISTING GROUND GRADE AS DIRECTED BY THE ENGINEER.

2) IN THE EVENT THAT THE MATERIAL UNDERLYING THE HAUL ROAD GRADE WILL NOT SUFFICIENTLY CONSOLIDATE TO ALLOW THE HAUL ROAD GRADE TO MATCH THE EXISTING GROUND GRADE, THE HAUL ROAD MATERIAL WILL NEED TO BE EXCAVATED OUT TO MATCH THE EXISTING GROUND GRADE, AS DIRECTED BY THE ENGINEER.

3) EXCAVATED MATERIALS MY BE DISPOSED OF IN LOW AREAS SOUTH OF STA. 115+00 AS DIRECTED BY THE ENGINEER.

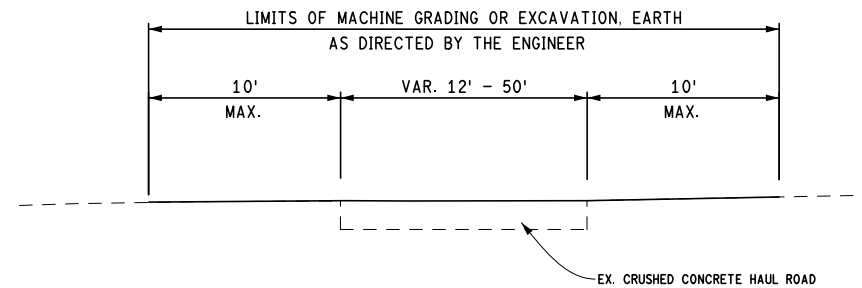

PROPOSED CROSS SECTION
TO APPLY
STA. 115+00 TO STA. 125+00

FINAL ROW PLAN REVISIONS				(SUBMITTAL DATE:)					NO SCALE	DATE: 03/29/18	CS: 03041	HAUL ROAD TYPICAL CROSS SECTIONS	DRAWING	SHEET	
NO.	DATE	AUTH	DESCRIPTION	NO.	DATE	AUTH	DESCRIPTION			DESIGN UNIT: FRANKLIN	JN: 107575A		M-222 AT THE KALAMAZOO RIVER		
										FILE: 107575 2018 SLOPE typ.dgn	TSC: GRAND RAPIDS			M-222 TYP 1	SECT

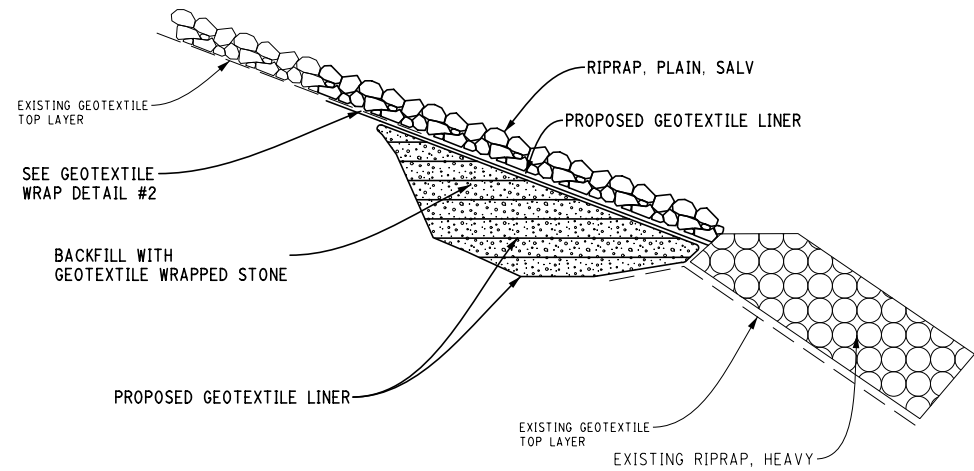

LOCATION #1
 APPROXIMATE SETTLEMENT DIMENSIONS:
 L = 19', W = 19', D = 9'

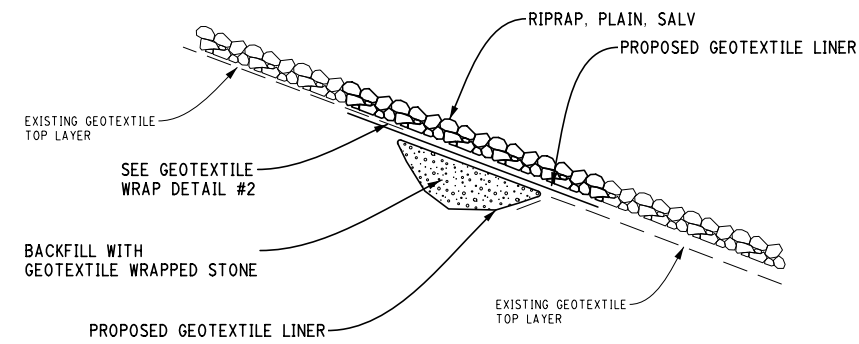

LOCATION #2
 APPROXIMATE SETTLEMENT DIMENSIONS:
 L = 9', W = 9', D = 3'

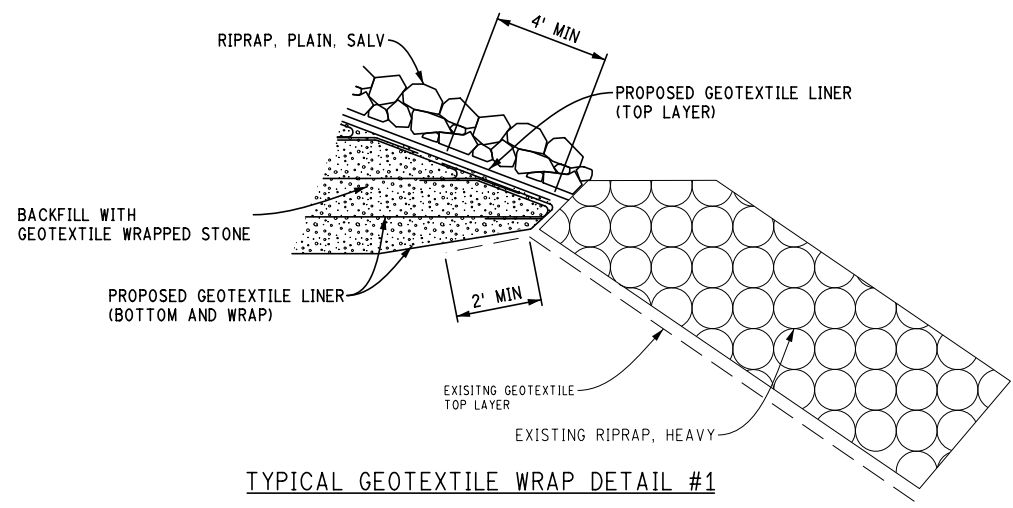

TYPICAL GEOTEXTILE WRAP DETAIL #1

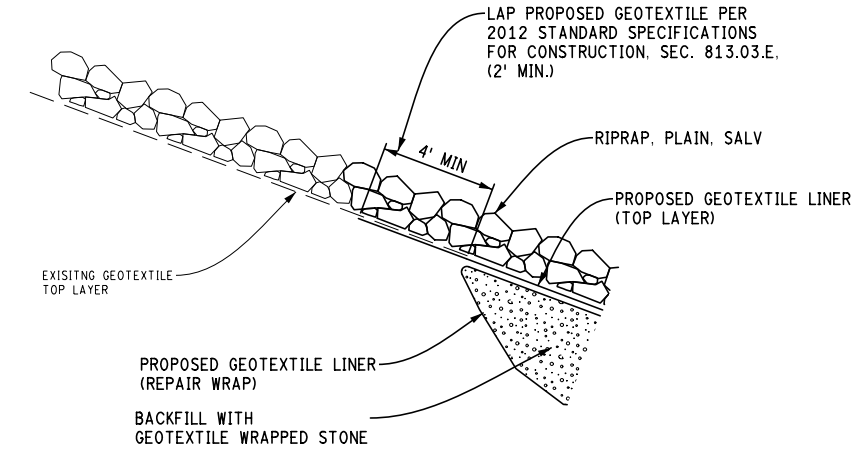

TYPICAL GEOTEXTILE WRAP DETAIL #2

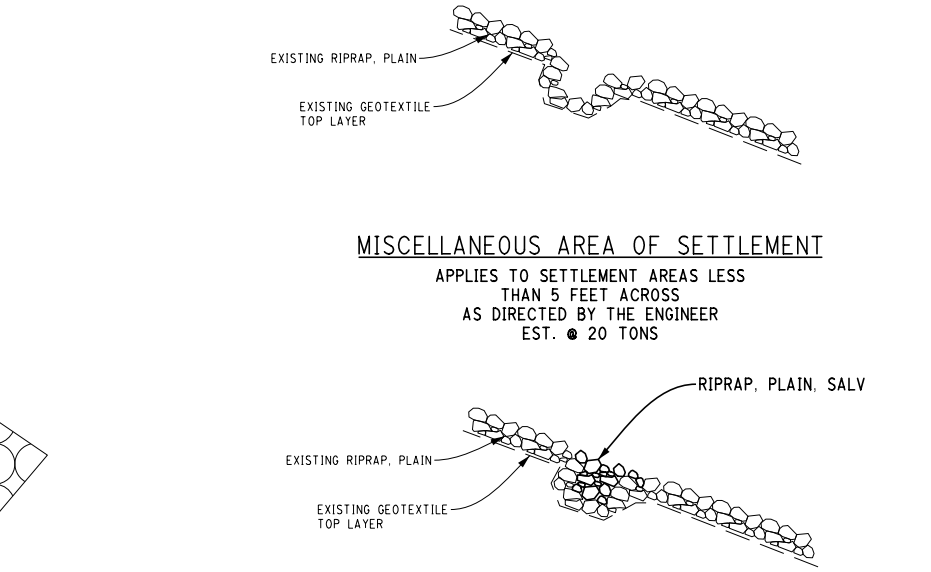

MISCELLANEOUS AREA OF SETTLEMENT
 APPLIES TO SETTLEMENT AREAS LESS THAN 5 FEET ACROSS AS DIRECTED BY THE ENGINEER EST. ● 20 TONS

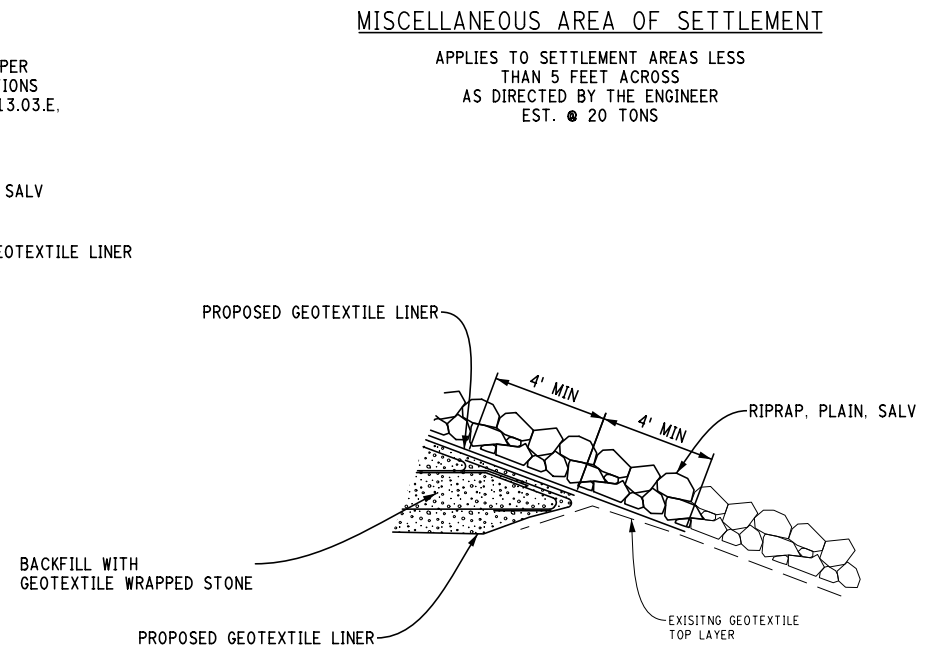

TYPICAL GEOTEXTILE WRAP DETAIL #3

FINAL ROW PLAN REVISIONS (SUBMITTAL DATE:)								MDOT Michigan Department of Transportation		NO SCALE		DATE: 06/14/18		CS: 03041		SLOPE REPAIR DETAILS		DRAWING SHEET	
NO.	DATE	AUTH	DESCRIPTION	NO.	DATE	AUTH	DESCRIPTION					M-222 AT THE KALAMAZOO RIVER		M-222		SECT			
								FILE: 107575 2018 SLOPE Det.dgn		TSC: GRAND RAPIDS		JN: 107575A		DET		1			

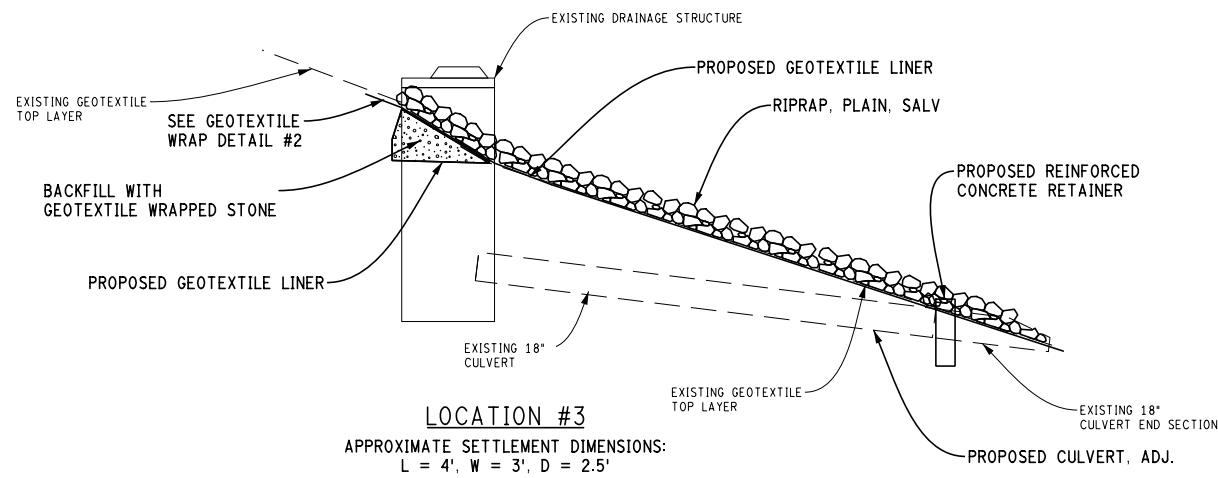

LOCATION #3
 APPROXIMATE SETTLEMENT DIMENSIONS:
 L = 4', W = 3', D = 2.5'

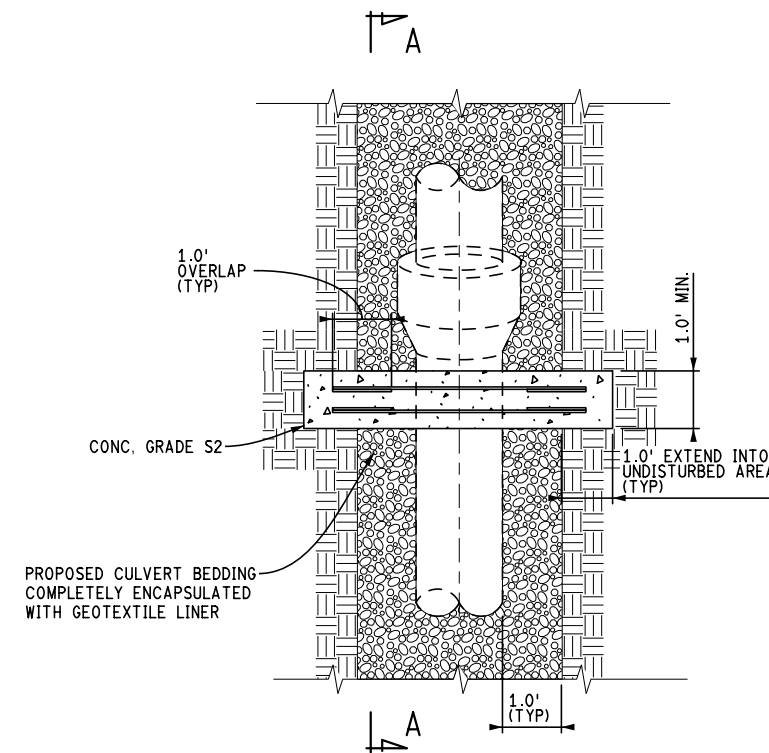

REINFORCED CONCRETE RETAINER DETAIL

EA BAR

BAR	NO. REQ'D	TOTAL WT
EA040706	4	20
EA040500	4	14
* OVERRUN		

BAR LEGEND
 * STEEL REINFORCEMENT NEEDED TO REPLACE WEAKENED REINFORCEMENT FOUND DURING DECK PREPARATION.

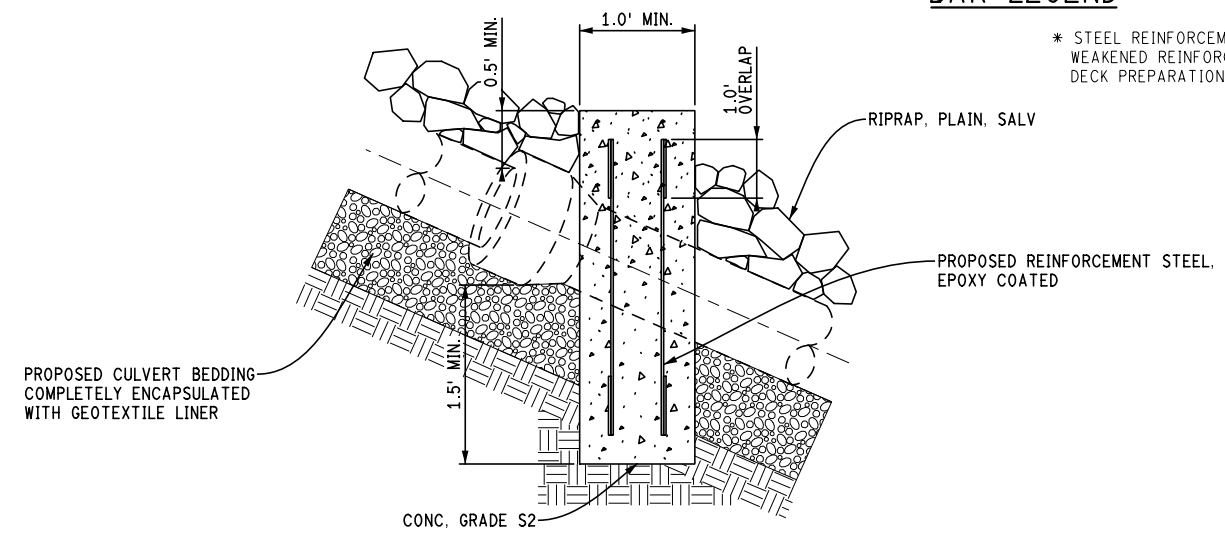

REINFORCED CONCRETE RETAINER SECTION A-A

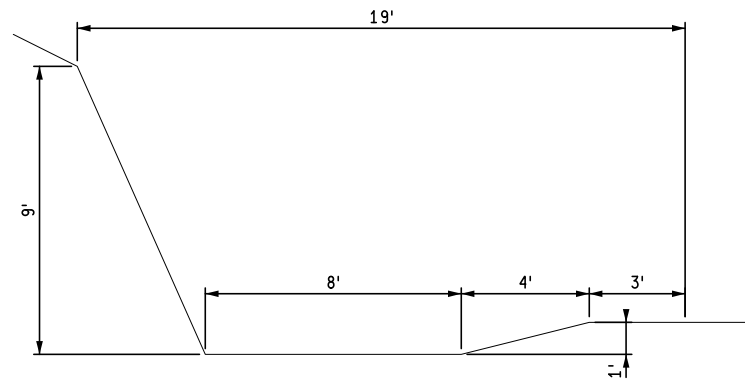

SECTION 1-1

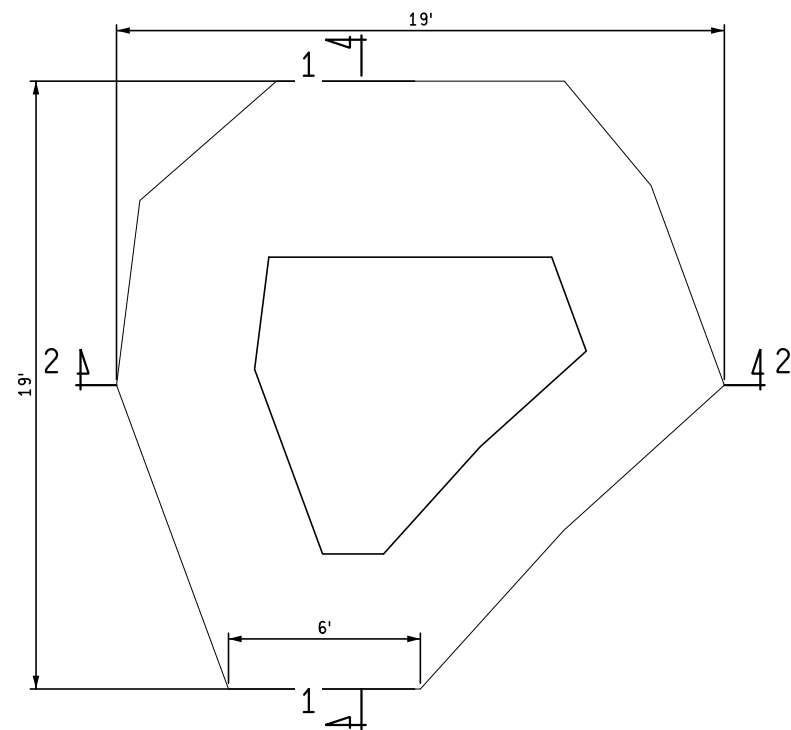

SECTION 2-2

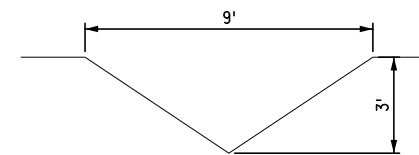
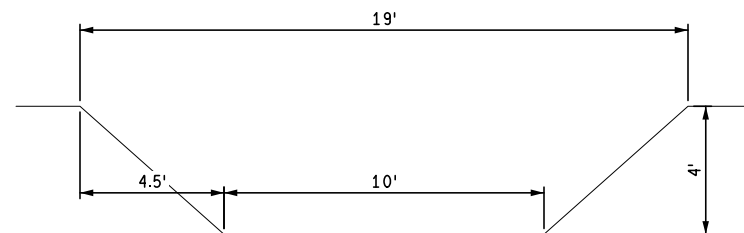

SECTION A-A

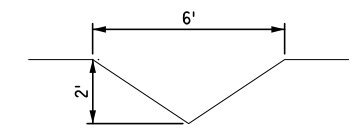
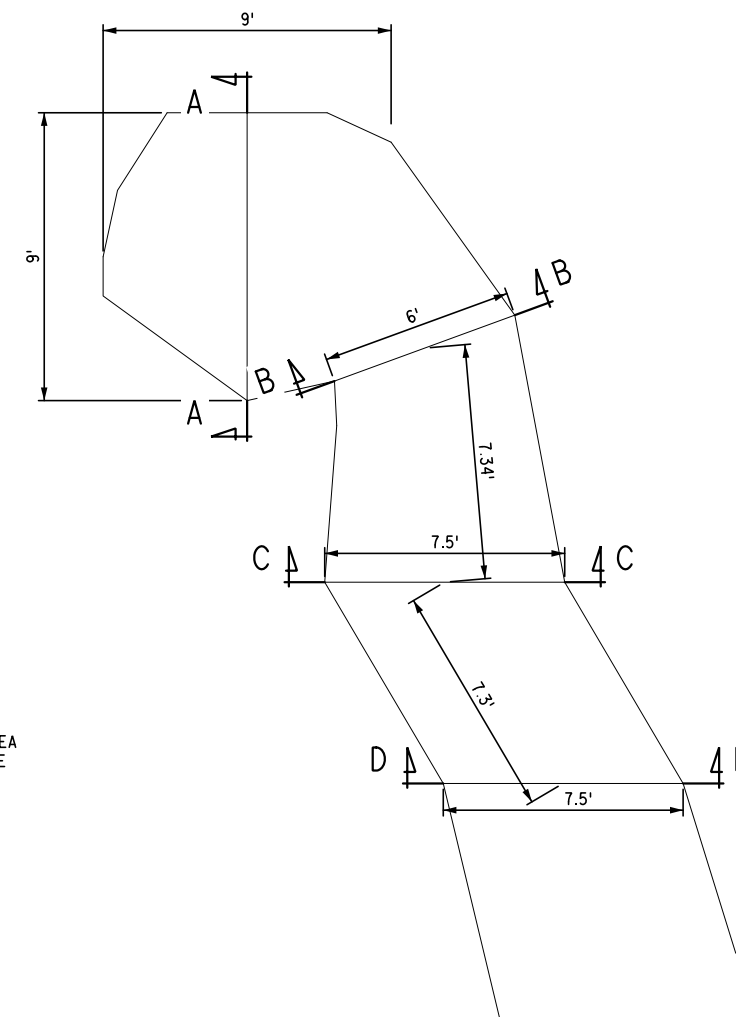

SECTION B-B

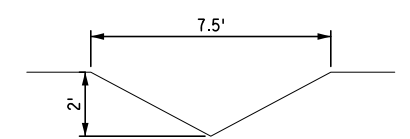

SECTION C-C

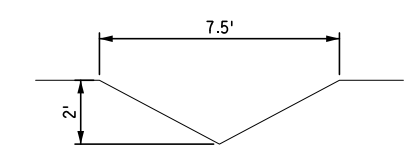

SECTION D-D

CLEAR EXISTING RIPRAP FROM FAILURE AREA
A MINIMUM OF 5' FROM THE EDGE OF THE
FAILURE AREA.

FINAL ROW PLAN REVISIONS				(SUBMITTAL DATE:)			
NO.	DATE	AUTH	DESCRIPTION	NO.	DATE	AUTH	DESCRIPTION



NO SCALE

DATE: 03/29/18	CS: 03041	DRAWING SHEET
DESIGN UNIT: FRANKLIN	JN: 107575A	
FILE: 107575 2018 SLOPE plan.dgn	TSC: GRAND RAPIDS	M-222 AT THE KALAMAZOO RIVER